



Lensmeter LM-10DX

Serving Your Vision



Lensmeter LM-10DX



“Find a point of eco-environment for our future”

- 1 The light source changed from a conventional electric bulb type to an LED type which decreases CO₂ emission and also reduces the electric power consumption.
- 2 The cross-line pinhole type target enables accurate measurement.
- 3 Internal power reading
- 4 The analog type can measure a subtle difference in lens power that is not possible with a digital type.

Specifications

Vertex Power	Range : +25 to -25D Step 0.125D up to $\pm 3D$ / 0.25D beyond $\pm 3D$
Prismatic power	Range 5 Δ (in a visual field)/20 Δ (with a compensator) Step 1 Δ
Cylindrical axis	Range : 0° to 180° Step 1°
Measurable lens diameter	Range : $\varnothing 20\text{mm}$ to $\varnothing 80\text{mm}$ Cross-line pinhole type
Eyepiece focusing	+6D to -6D
Tilting angle	30° to 90°
Power source	AC100-240V
Power consumption	1.0VA
Dimension	380(H) \times 403(D) \times 180(W)mm
Weight	4.9kg

* If you want to order the unit without prism compensator, please contact our sales department.

Dimensions

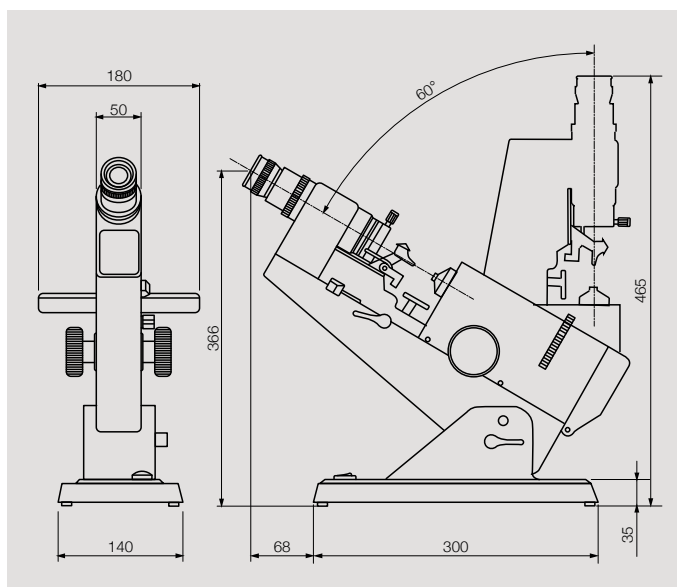

•Design and specifications are subject to change as improvements are made to the product.



For The Americas, Asia-Pacific & Middle East

TAKAGI SEIKO CO., LTD.

330-2 Iwafune, Nakano-shi, Nagano-ken, 383-8585, Japan
TEL : +81(0)269-22-4511(Switchboard) URL : <https://www.takagi-j.com>

For Europe & Africa

Takagi Ophthalmic Instruments Europe Ltd

Citylabs 1.0, Nelson Street, Manchester, M13 9NQ, UK
TEL : +44 (0)161 273 6330 URL : <https://www.takagieurope.com>



<https://www.takagi-global.com>

